

Daily Maintenance

Everyday Task List

Performing daily maintenance is important to maintain your print quality and your printer reliability. Please be sure to conduct daily maintenance.

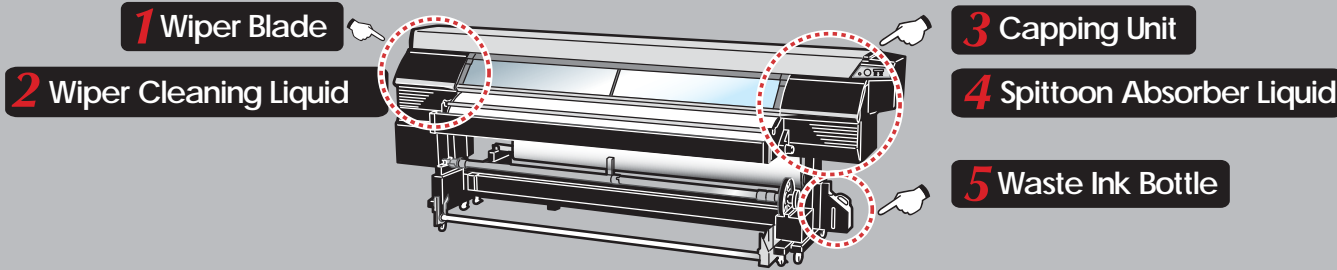

1 Check the wiper blade

✗ Bad

✗ Bad



If the wiper blade is stained or scratched, replace it

2 Check the wiper cleaning liquid level

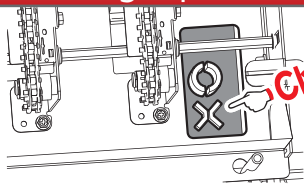

Check!

✗ When "X" appears on the tray, replenish the liquid

3 Clean the capping unit

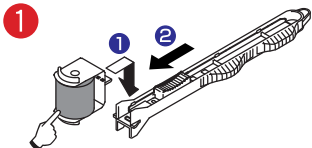

Use a new roller for each cleaning

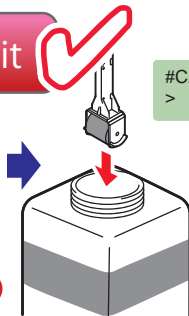

#CAP CLEANING

2 1x



3 10x

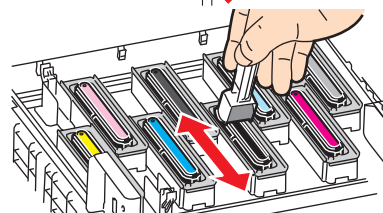

✗ Bad



○ Good



4 Check the spittoon absorber unit

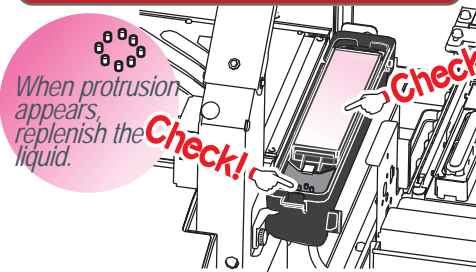

When protrusion appears, replenish the liquid. Check!

Check!

Replace the spittoon case if ink is accumulated

5 Check the waste ink bottle's ink level

If the waste ink level is above [Full] level, replace the bottle

Check!

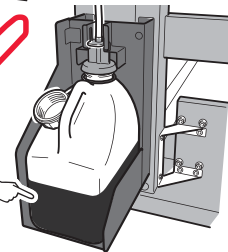

6 Clean the media edge guard



7 Check the print head surface is clean

#RESEAT PRINTHEAD



Check!



Manually slide the carriage and check no lint is adhered to the heads

8 Clean the print head

#PH RECOVERY
>NORMAL

9 Print the NOZZLE CHECK pattern

#TEST PRINTS
>NOZZLE PRINT

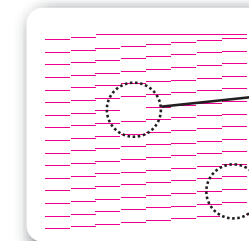

Check!

Check that all print head nozzles are working correctly

Daily Maintenance

Panel Operation

1 Clean the capping unit

PRINTER READY
ROLL: 1625 / PAPER



↑ INK MEDIA REG ↓
← MEDIA M. ADV →



↑ REWIND FORM FEED ↓
← PH. REC PH. MAIN →



#CAP CLEANING
>

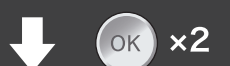

CARRIAGE MOVING
PLEASE WAIT



OPEN COVER
CLEAN CAP

2 Clean the carriage

PRINTER READY
ROLL: 1625 / PAPER



↑ INK MEDIA REG ↓
← MEDIA M. ADV →



↑ REWIND FORM FEED ↓
← PH. REC PH. MAIN →



#CAP CLEANING
>



#RESEAT PRINTHEAD
>



OPEN COVER
RESEAT PRINTHEAD

3 Perform normal cleaning

PRINTER READY
ROLL: 1625 / PAPER



↑ INK MEDIA REG ↓
← MEDIA M. ADV →



↑ REWIND FORM FEED ↓
← PH. REC PH. MAIN →



#PH RECOVERY
>NORMAL



#PH RECOVERY
*NORMAL



#PH RECOVERY 87654321
*NORMAL



#PH REC 87654321
*BOTTLE OK?



#PH RECOVERY
*CLEANING

4 Print the nozzle print pattern

PRINTER READY
ROLL: 1625 / PAPER



↑ INK MEDIA REG ↓
← MEDIA M. ADV →

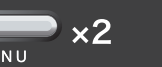

↑ PRINTER SETUP ↓
← ADJUST HEATER →



#TEST PRINTS
>NOZZLE PRINT



#TEST PRINTS
*NOZZLE PRINT

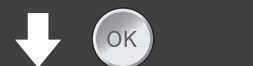

#TEST PRINTS
*OK?



#TEST PRINTS
*EXECUTING